

# Nedmac, Inc.

*Precision Machining Since 1954*  
5410 International Parkway  
New Hope, MN 55428-3697

[www.nedmac.com](http://www.nedmac.com)

- ✓ CNC MILLING
- ✓ CNC TURNING
- ✓ TOOLROOM/GRINDING
- ✓ WELDING/ASSEMBLY
- ✓ TUMBLING/BURNISHING



**Nedmac, Inc.** has been supplying local and national customers since 1954. A privately owned contract machine shop providing services to the aerospace, electronics, medical, optical, scientific, robotic, food processing, and sporting goods industries with precision machined parts, tooling, and assemblies.

**Nedmac, Inc.** is located in the Science Industry Center of New Hope. Our clean 18,000 square foot air-conditioned facility provides the atmosphere for precision machining. Our modern CNC milling and turning departments work well for prototyping, as well as short to long run production. We use our manual milling, turning, and grinding departments for prototypes, short run production, as well as a tool room for custom fixtures and assemblies. Part finish requirements are enhanced by our burnishing-tumbling department. One specialty is the custom inspection tooling we make for our customers own inspection departments.

We regularly work on all steels, tool steels, stainless steels, aluminum, copper and brass alloys, plastics and many specials such as macor, kovar, niobium, molybdenum, tantalum, titanium, etc.

Management and all its employees are committed to serving our customers with top quality at competitive pricing and on-time delivery.

We would appreciate the opportunity to help you in any of your machining needs. Check out our website and give us a call. We pride ourselves in working with our customers and getting them what they need.

Thank you for your time.

We look forward to being of service to you and your company.

[James A. Tilbury](#)

*President*

763-537-8435 ext. 202

[jtilbury@nedmac.com](mailto:jtilbury@nedmac.com)

[Dennis D. Kuss](#)

*Vice President*

763-537-8435 ext. 203

[dkuss@nedmac.com](mailto:dkuss@nedmac.com)

**FACILITIES LIST ON BACK SIDE.**

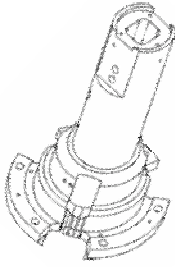

**Nedmac, Inc.**  
 The Trusted Name In Precision  
 Machining Since 1954.

**TOP QUALITY AT COMPETITIVE  
 PRICING WITH ON TIME DELIVERY.**

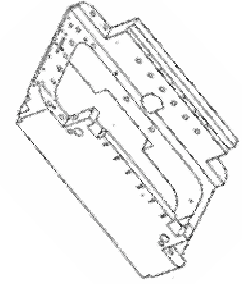

**Vertical CNC Machining Centers:**

- ( 3 ) Fadal VMC 3016 / 4<sup>th</sup> axis / 30" x 16" x 20"
- ( 1 ) Fadal VMC 4020 / 40" x 20" x 20"
- ( 4 ) Hurco BMC 3017 / 4<sup>th</sup> axis / 30" x 17" x 24"
- ( 2 ) Acroloc Series 10 / 4<sup>th</sup> axis / 32" x 17" x 24"
- ( 2 ) Daewoo DMV3016L / 30" x 16" x 20"

**CNC Turning Centers:**

- ( 1 ) Hardinge CHNC I / 4.5" x 12" x 14"
- ( 2 ) Hardinge CHNC II Plus / 4.5" x 12" x 14"
- ( 4 ) Hardinge Conquest GT27 SP / 12"x11"x11.75"
- ( 1 ) Hardinge Quest 51 SP / 7.45" x 24" x 20.44"
- ( 1 ) Hardinge Talent 6/45 / 9" x 16" x 18"

**Programing systems:**

Surfcam Velocity II  
and  
Winmax PC Plus

**Milling:**

- ( 5 ) Bridgeport mills
- ( 1 ) Hauser jig bore
- ( 3 ) Clausing mills

**Grinding:**

Hydraulic:

- ( 1 ) Boyer Schultz surface grinder
- ( 1 ) Myford cylindrical grinder
- ( 1 ) Nicco surface grinder
- ( 1 ) Okamoto surface grinder

Manual:

- ( 3 ) Boyer Schultz surface grinders

**Lathe:**

- ( 2 ) Hardinge chucks
- ( 4 ) Hardinge second operation lathes
- ( 2 ) Hardinge speed lathe
- ( 3 ) Sheldon engine lathes

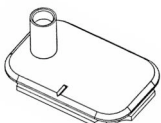

**Stamping:**

- ( 9 ) Havir punch presses, 5 ton to 35 ton.

**Miscellaneous:**

- ( 5 ) Drill presses
- ( 6 ) Millman lead screw tappers
- ( 1 ) Flexarm Tapper S-36
- ( 4 ) Barrel tumblers, various sizes
- ( 1 ) Sintobrotor barrel finisher
- ( 1 ) Harperizer
- ( 2 ) Micro blaster
- ( 1 ) Doall band saw
- ( 1 ) Grob band saw
- ( 1 ) Doall cut off saw
- ( 6 ) Belt sanders, various sizes
- ( 1 ) Kwik Way centerless sander
- ( 1 ) Gorton universal cutter grinder
- ( 1 ) Christian drill grinder
- ( 1 ) Black Diamond drill grinder
- ( 2 ) Heat treat ovens
- ( 2 ) Arbor Presses
- ( 1 ) Sunnen hone
- ( 1 ) McGregor DC 1000
- ( 4 ) station welder/ VTA60 heads
- ( 2 ) Hughes HCD 300 welder/ VTA60 heads

**Inspection:**

Complete Facility to Mil-I-45208  
( 1 ) Nikon V-12 Profile Projector  
( 1 ) Numerex CMM  
Deltronic gage pins..011 thru 1.000 +  
Numerous inspections scopes.  
Surface analyzer, Hardness tester, Numerous  
micrometers, Bore gages, Etc.

Plus much more, too numerous to mention.

**MORE INFORMATION  
ON FRONT SIDE.**